

SST LIST & SPECIFICATIONS

SST LIST	9 – 1
Standard Parts Tightening Torques	9 – 7
Main Parts Tightening Torques	9 – 8
Specifications	9 – 10

CLUTCH, TRANSMISSION



1

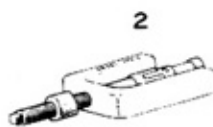

2



3



4



5



6



7

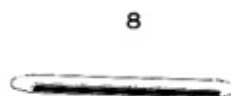

8

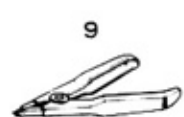

9

10



11



12



- | | | |
|----|-------------|---|
| 1 | 09301-36010 | Tool, Clutch guide (4, 5 speeds) |
| | 09301-20020 | Tool, Clutch guide (3 speeds) |
| 2 | 09303-35010 | Puller, Input shaft front bearing |
| 3 | 09304-12011 | Replacer, Input shaft front bearing |
| 4 | 09308-10010 | Puller, Oil seal |
| 5 | 09307-30010 | Replacer, Extension housing bush (3 speeds) |
| 6 | 09307-12010 | Replacer, Extension housing bush (4, 5 speeds) |
| 7 | 09325-12010 | Plug, Transmission oil (4, 5 speeds) |
| | 09325-20010 | Plug, Transmission oil (3 speeds) |
| 8 | 09311-20011 | Shaft, Counter gear needle roller guide (3 speeds) |
| 9 | 09905-00010 | Expander, Snap Ring, No. 1 |
| 10 | 09326-20010 | Wrench, Output shaft nut (3 speeds) |
| 11 | 09326-20020 | Wrench, Output shaft (3 speeds) |
| 12 | 09326-12011 | Wrench, Output shaft bearing lock nut (4, 5 speeds) |

PROPELLER SHAFT, DIFFERENTIAL

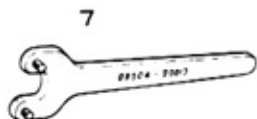
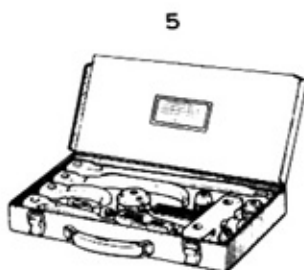
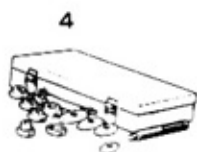
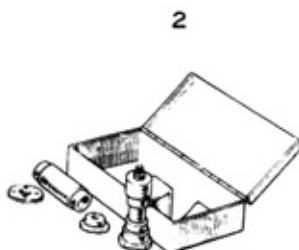

- | | | |
|---|-------------|--|
| 1 | 09332-30010 | Adaptor, Universal joint bearing |
| 2 | 09530-20010 | Gauge, Diff. |
| 3 | 09330-00010 | Tool, Companion flange holding |
| 4 | 09608-20010 | Tool set, Front hub and drive pinion bearing |
| 5 | 09950-20010 | Puller, Universal |
| 6 | 09506-30010 | Replacer, Diff. rear bearing cone |
| 7 | 09504-20010 | Wrench, Diff. side bearing |
| 8 | 09505-20010 | Replacer, Diff. side bearing |

FRONT AXLE

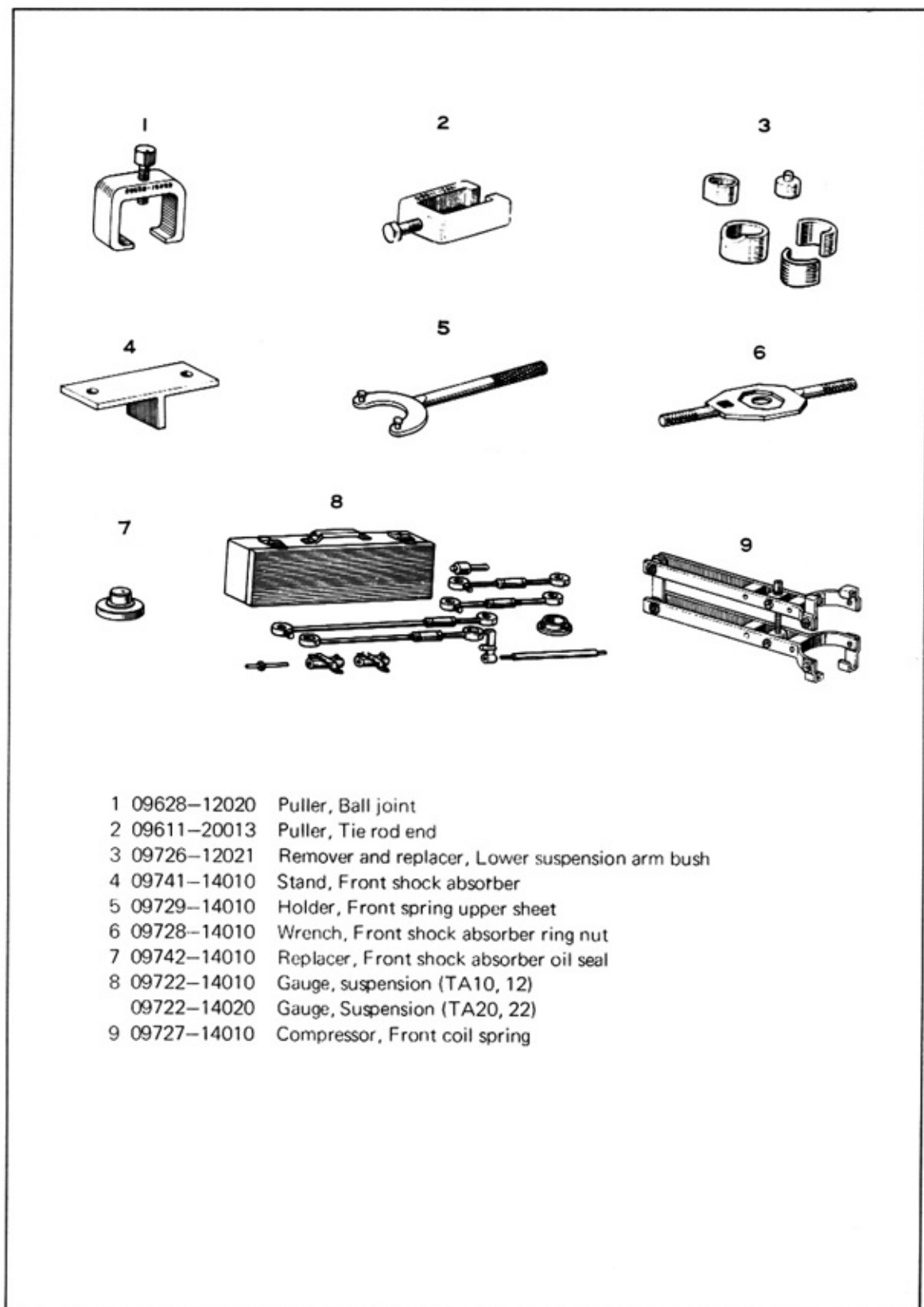

- | | | |
|---|-------------|---|
| 1 | 09628-12020 | Puller, Ball joint |
| 2 | 09611-20013 | Puller, Tie rod end |
| 3 | 09726-12021 | Remover and replacer, Lower suspension arm bush |
| 4 | 09741-14010 | Stand, Front shock absorber |
| 5 | 09729-14010 | Holder, Front spring upper sheet |
| 6 | 09728-14010 | Wrench, Front shock absorber ring nut |
| 7 | 09742-14010 | Replacer, Front shock absorber oil seal |
| 8 | 09722-14010 | Gauge, suspension (TA10, 12) |
| | 09722-14020 | Gauge, Suspension (TA20, 22) |
| 9 | 09727-14010 | Compressor, Front coil spring |

REAR AXLE

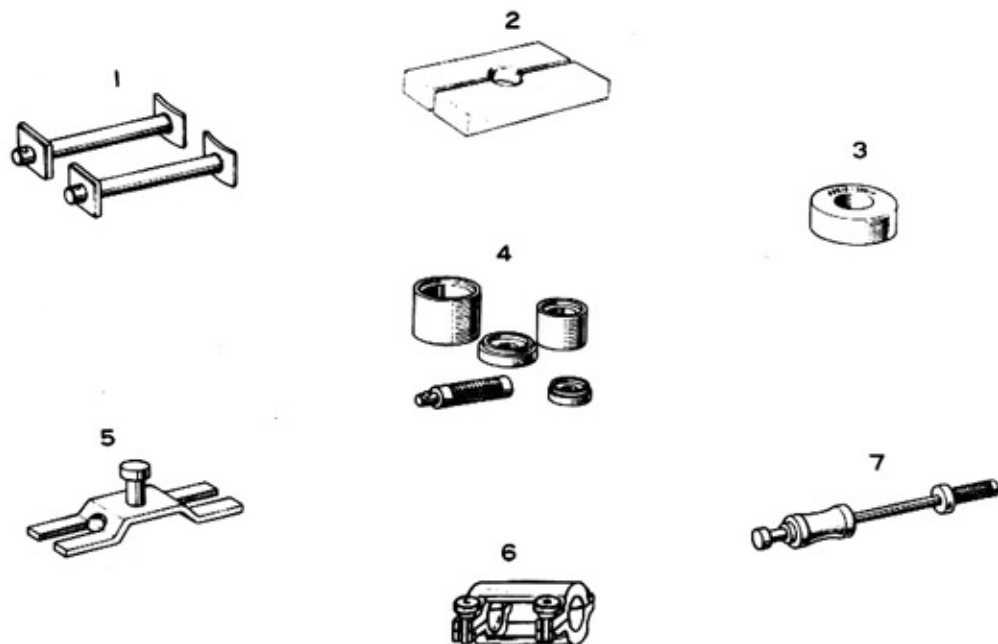

- | | | |
|---|-------------|------------------------------------|
| 1 | 09732-14010 | Gauge, Rear axle height |
| 2 | 09527-20011 | Remover, Rear axle shaft bearing |
| 3 | 09515-20010 | Replacer, Rear axle shaft bearing |
| 4 | 09710-14010 | Tool set, Rear suspension bush |
| 5 | 09914-00011 | Attachment, Rear axle shaft puller |
| 6 | 09911-00010 | Clamp, Puller |
| 7 | 09912-00010 | Hammer, Slide |

STEERING

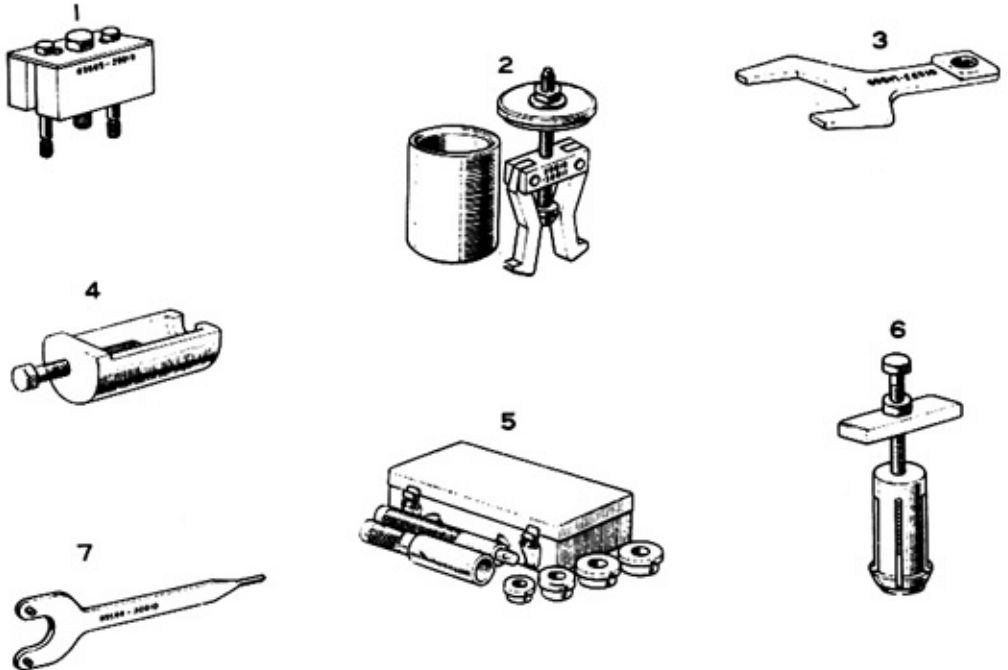

- | | | |
|---|-------------|---|
| 1 | 09609-20010 | Puller, Steering wheel |
| 2 | 09612-30011 | Puller, Steering worm bearing |
| 3 | 09617-22020 | Wrench, Worm bearing adjust screw lock nut |
| 4 | 09610-20011 | Puller, Pitman Arm |
| 5 | 09620-30010 | Replacer set, Steering gear box |
| 6 | 09615-30010 | Puller, Steering sector shaft bush |
| 7 | 09616-22010 | Wrench, Steering worm bearing adjusting screw |

BRAKE BODY

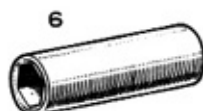
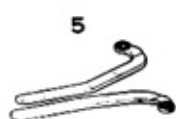
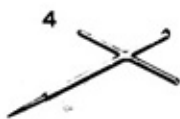
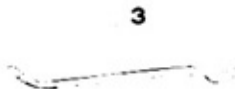
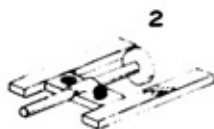

- | | | |
|---|--------------|--|
| 1 | 09738--22011 | Remover, Brake booster rear shell |
| 2 | 09737--22011 | Gauge, Brake booster push rod |
| 3 | 09704--10010 | Tool, Brake adjusting |
| 4 | 09703--30010 | Tool, Brake shoe return spring |
| 5 | 09812--30011 | Wrench set, Door hinge set bolt |
| | 09812--14010 | Wrench set, Door hinge set bolt (TA20, 22) |
| 6 | 09814--20010 | Wrench, Outer rear mirror |

STANDARD BOLT CLASSIFICATION

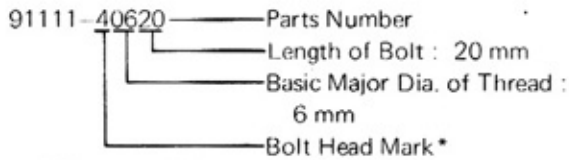

* Bolt Head Mark has the following indications. Fig. 10-1 Bolt

Mark on head of bolt	4	5	7
Toyota Standard Classification	4T	5T	7T
Tensile Strength (kg/mm ²)	more than 42	more than 55	more than 75
Brinell Hardness Number	121–209	147–227	227–271
Rockwell Hardness Number	B70–95	B89–98	C20–28
Yield Point (kg/mm ²)	more than 30	more than 45	more than 60

STANDARD BOLT TIGHTENING TORQUE

Class	Basic Dia.	Pitch	Standard Torque m-kg (ft-lb)	Torque Limit m-kg (ft-lb)
4T	6	1	0.47 (3.4)	0.4– 0.7 (2.9– 5.0)
	8	1.25	1.11 (8.0)	1.0– 1.6 (7.3– 11.6)
	10	1.25	2.25 (16.3)	1.9– 3.1 (13.7– 22.4)
	10	1.5	2.14 (15.5)	1.8– 3.0 (13.0– 21.7)
	12	1.5	3.89 (28.1)	3.5– 5.5 (25.3– 39.8)
	12	1.75	3.74 (27.0)	3.0– 5.0 (21.7– 36.2)
	13	1.5	5.08 (36.8)	4.5– 7.0 (32.5– 50.6)
	14	1.5	6.33 (45.8)	5.0– 8.0 (36.2– 57.8)
	14	2	5.93 (42.8)	4.7– 7.7 (34.0– 55.7)
	16	1.5	9.57 (69.2)	7.5–11.0 (54.2– 79.6)
5T	6	1	0.71 (5.1)	0.6– 0.9 (4.4– 6.5)
	8	1.25	1.66 (12.0)	1.5– 2.2 (10.9– 15.9)
	10	1.25	3.34 (24.1)	3.0– 4.5 (21.7– 32.5)
	10	1.5	3.22 (23.3)	2.7– 4.2 (19.5– 30.4)
	12	1.5	5.84 (42.2)	5.0– 7.0 (36.2– 50.6)
	12	1.75	5.61 (40.6)	4.8– 6.8 (34.7– 49.2)
	13	1.5	7.63 (55.2)	6.5– 9.0 (47.0– 65.1)
	14	1.5	8.90 (65.3)	7.5–11.0 (54.2– 79.6)
	14	2	9.50 (68.7)	7.0–10.5 (50.6– 75.9)
	16	1.5	14.36 (103.8)	12.0–17.0 (36.8–123.0)
7T	6	1	0.95 (6.9)	0.8– 1.2 (5.8– 8.6)
	8	1.25	2.21 (16.1)	2.0– 3.0 (14.5– 21.7)
	10	1.25	4.49 (32.5)	4.0– 5.5 (28.9– 39.8)
	10	1.5	4.29 (31.0)	3.7– 5.2 (26.8– 37.6)
	12	1.5	7.78 (56.2)	7.0– 9.0 (50.6– 65.1)
	12	1.75	7.48 (54.1)	6.0– 8.5 (43.3– 61.4)
	13	1.5	10.17 (73.5)	8.0–12.0 (57.8– 86.8)
	14	1.5	12.67 (91.6)	10.0–15.0 (72.3–108.5)
	14	2	11.86 (85.8)	9.5–14.0 (68.7–101.2)
	16	1.5	19.15 (138.5)	15.0–23.0 (108.5–166.2)
16	2	18.11 (131.0)	14.0–22.0 (101.2–159.0)	

Note : The above specified tightening torque is applicable only for female threads cut into a steel material. If the female threads are cut in other materials than steel, and also tightening surface are encountered to heat or vibrations, these specified tightening torque must be reconsidered.

SPECIFIED PARTS TIGHTENING TORQUE LIMITS

CLUTCH

Tightening Parts	Torque Limits m-kg (ft-lb)
Clutch Cover to Flywheel	1.5 ~ 2.0 (11.1 ~ 11.5)
Clutch Housing to Engine	4.8 ~ 6.8 (34.6 ~ 49.2)
Master Cylinder Reservoir Set Bolt	2.0 ~ 3.0 (14.5 ~ 21.7)
Release Fork Support to Transmission case	1.9 ~ 3.1 (13.7 ~ 22.4)

TRANSMISSION

Tightening Parts	Torque Limits m-kg (ft-lb)
Shift Lever Shaft Housing to Transmission Case	1.0 ~ 1.6 (7.2 ~ 11.6)
Clutch Housing to Transmission Case	3.0 ~ 4.5 (21.7 ~ 32.5)
Front Bearing Retainer to Transmission Case	1.0 ~ 1.6 (7.2 ~ 11.6)
Extension Housing to Transmission Case	3.0 ~ 4.5 (21.7 ~ 32.5)
Oil Pan to Transmission Case	0.55 ~ 0.7 (4.0 ~ 5.1)
Output Shaft Bearing Nut	4.5 ~ 7.5 (32.5 ~ 54.2)
Reverse Idler Shaft Retaining Bolt	1.3 ~ 1.8 (0.4 ~ 13.0)
Drain Plug	2.5 ~ 3.0 (1.8 ~ 23.5)

3 SPEED TOYOGLIDE AUTOMATIC TRANSMISSION

Tightening parts	Torque Limits m-kg (ft-lb)
First & Reverse Drum to Planetary Carrier	30 ~ 4.0 (21.7 ~ 28.9)
Front Oil Pump Body to Stator Shaft :	
6 mm bolt	0.6 ~ 0.9 (4.3 ~ 6.5)
8 mm bolt	1.9 ~ 2.2 (13.7 ~ 15.9)
Oil Pan to Transmission Case	0.5 ~ 0.8 (3.6 ~ 5.8)
Drive Plate & Ring Gear to Crankshaft	4.5 ~ 6.0 (32.5 ~ 43.4)
Front Oil Pump to Transmission Case	1.4 ~ 1.8 (10.1 ~ 13.0)
Rear Oil Pump to Transmission Case	0.7 ~ 1.1 (5.1 ~ 8.0)
Valve Body to Transmission Case	1.0 ~ 1.2 (7.2 ~ 8.7)
Front Servo Body to Transmission Case	1.8 ~ 2.2 (13.0 ~ 15.9)
Rear Servo Body to Transmission Case	2.5 ~ 3.0 (18.1 ~ 21.7)
Extension Housing to Transmission Case	1.8 ~ 2.0 (13.0 ~ 14.5)

2 SPEED TOYOGLIDE AUTOMATIC TRANSMISSION

Tightening Parts	Torque Limits m·kg (ft·lb)
Drive Plate to Crankshaft	4.5 ~ 6.0 (32.5 ~ 43.0)
Drive Plate to Torque Converter	1.0 ~ 1.6 (7.2 ~ 11.6)
Transmission Housing to Engine	5.0 ~ 7.0 (36.2 ~ 50.6)
Transmission Housing to Transmission Case	3.0 ~ 4.5 (21.7 ~ 32.5)
Oil Pan to Transmission Case	0.4 ~ 0.7 (2.9 ~ 5.1)
Valve Body to Transmission Case	0.4 ~ 0.7 (2.9 ~ 5.1)
Front Oil Pump to Transmission Case	1.0 ~ 1.6 (7.2 ~ 11.6)
Front Oil Pump Body to Pump Cover	0.6 ~ 1.6 (4.3 ~ 11.6)
Rear Oil Pump Body to Transmission Case	1.0 ~ 1.6 (7.2 ~ 11.6)
Extension Housing to Transmission Case	1.0 ~ 1.6 (7.2 ~ 11.6)
Governor Body Lock Screw	0.8 ~ 1.9 (5.8 ~ 7.2)
Governor Body to Governor Body Support	0.6 ~ 1.0 (4.3 ~ 7.2)
Oil Pan Drain Plug	2.7 ~ 3.3 (19.5 ~ 23.9)
Low Brake Band Anchor Bolt Lock Nut	2.3 ~ 3.1 (16.0 ~ 22.4)

PROPELLER SHAFT

Tightening Parts	Torque Limits m·kg(ft·lb)
Universal Joint Flange Yoke to Universal Joint Flange	1.5 ~ 2.2 (10.8 ~ 15.9)

REAR AXLE & REAR SUSPENSION

Tightening parts	Torque Limits m·kg (ft·lb)
Differential Case to Ring Gear	7.0 ~ 8.0 (50.6 ~ 57.9)
Differential Drive Pinion to Companion Flange	17.0 ~ 20.0 (123j0 ~ 144.7)
Differential Bearing Cap to Differential Carrier	5.0 ~ 7.0 (36.2 ~ 50.6)
Differential Carrier to Rear Axle Housing	2.5 ~ 3.8 (18.1 ~ 27.5)
Backing Plate & Bearing Outer Retainer to Rear Axle Housing	4.0 ~ 5.0 (28.9 ~ 5.7)
Differential Case Cover to Differential Case	2.5 ~ 3.5 (18.1 ~ 25.3)
Drain Plug	3.7 ~ 4.3 (26.8 ~ 31.1)
Filler Plug	2.7 ~ 3.3 (19.5 ~ 23.9)
Breather Plug to Rear Axle Housing	1.9 ~ 3.1 (13.7 ~ 22.4)
"U" Bolt Nut	4.0 ~ 5.5 (28.9 ~ 39.8)

FRONT SUSPENSION

Tightening Parts	Torque Limits m·kg (ft·lb)
Upper Arm Shaft to Suspension Member	4.5 ~ 6.0 (32.5 ~ 43.4)
Lower Arm to Suspension Member	4.5 ~ 6.0 (32.5 ~ 43.4)
Upper Ball Joint to Steering Knuckle	4.0 ~ 5.5 (28.9 ~ 39.8)
Lower Ball Joint to Steering Knuckle	7.0 ~ 9.0 (50.6 ~ 65.1)
Steering Knuckle Arm to Steering Knuckle	5.5 ~ 7.0 (39.8 ~ 50.6)
Backing Plate to Steering Knuckle	5.5 ~ 7.0 (39.8 ~ 50.6)
Disc Brake Dust Cover to Steering Knuckle	5.5 ~ 7.0 (39.8 ~ 50.6)
Shock Absorber Upper to Suspension Member	1.9 ~ 3.1 (13.7 ~ 22.4)
Shock Absorber Lower to Lower Arm	1.5 ~ 2.2 (10.8 ~ 15.9)
Wheel Nut to Front Wheel Hub	9.0 ~ 12.0 (65.1 ~ 86.8)

STEERING

Tightening Parts	Torque Limits m·kg (ft·lb)
Steering Wheel to Steering Main Shaft	2.0 ~ 3.0 (14.5 ~ 21.7)
Flexible Coupling to Steering Worm Shaft	2.0 ~ 3.0 (14.5 ~ 21.7)
Steering Gear Housing to Frame	3.5 ~ 5.0 (25.3 ~ 36.2)
Sector Shaft End Cover to Steering Gear Housing	1.5 ~ 2.0 (10.8 ~ 14.5)
Pitman Arm to Steering Sector Shaft	11.0 ~ 14.0 (79.6 ~ 101.3)
Steering Idler Arm to Steering Idler Arm Support	7.0 ~ 9.0 (50.6 ~ 65.1)
Pitman Arm to Steering Relay Rod	5.0 ~ 7.0 (36.2 ~ 50.6)
Steering Idler Arm Support to Frame	3.5 ~ 5.0 (25.3 ~ 36.2)
Steering Relay Rod to Steering Tie Rod	4.5 ~ 6.5 (32.5 ~ 47.0)
Steering Knuckle Arm to Steering Tie Rod	5.0 ~ 7.0 (36.2 ~ 65.1)

BRAKES

Tightening parts	Torque limits m·kg (ft·lb)
Pedal Bracket to Cowl Panel	1.0 ~ 1.6 (7.2 ~ 11.6)
Wheel Brake Cylinder to Backing Plate	0.8 ~ 1.2 (5.8 ~ 8.7)
Union Bolt to Wheel Brake Cylinder	2.7 ~ 3.5 (19.5 ~ 25.3)
Breather Plug to Wheel Brake Cylinder	1.0 ~ 1.3 (7.2 ~ 9.5)
Flexible Hose to Brake Tube	1.3 ~ 1.8 (9.4 ~ 13.0)
Master Cylinder Reservoir Set Bolt to Master Cylinder Body	2.0 ~ 3.0 (14.5 ~ 21.7)
Disc Brake Mounting to Caliper Support Bracket	7.0 ~ 9.0 (50.6 ~ 65.1)
Brake & Clutch Pedal Attaching Bolt	4.8 ~ 6.8 (34.7 ~ 49.2)

CLUTCH

Pedal Height	mm (in)	161 (6.3)	
Pedal	mm (in)	1.0 ~ 3.0 (0.04 ~ 0.12)	
Release Fork	mm (in)	2.0 ~ 3.5 (0.08 ~ 0.138)	
Facing	Thickness Limit	mm (in)	0.3 (0.012)
	Vibration Limit	mm (in)	0.5 (0.020)
Installing Weight (Diaphragm)	kg (lb)	365 (749.6)	

TRANSMISSION

MANUAL TRANSMISSION (1)

Vehicle Model		3 Speeds	4 & 5 Speeds	RA20L	
Shift Ratio	First Speed	3.337	3.587	3.579	
	Second Speed	1.653	2.022	2.081	
	Third Speed	1.000	1.384	1.397	
	Fourth Speed	—	1.000	1.000	
	Fifth Speed	—	0.861	—	
	Reverse	4.449	3.484	4.399	
Thrust Clearance	Counter Gear	Standard mm (in)	0.12 ~ 0.29 (0.005 ~ 0.011)	—	—
		Limit mm (in)	0.5 (0.020)	—	0.25
	First Gear	Standard mm (in)	0.10 ~ 0.25 (0.004 ~ 0.010)	0.15 ~ 0.25 (0.006 ~ 0.010)	—
		Limit mm (in)	0.5 (0.020)	—	0.25
	Second Gear	Standard mm (in)	0.10 ~ 0.25 (0.004 ~ 0.010)	0.15 ~ 0.25 (0.006 ~ 0.010)	—
		Limit mm (in)	—	0.6 (0.024)	0.25
	Third Gear	Standard mm (in)	—	0.15 ~ 0.30 (0.006 ~ 0.012)	0.1 ~ 0.25
		Limit mm (in)	—	0.5 (0.020)	—
	Fifth Gear	Standard mm (in)	—	0.15 ~ 0.25 (0.006 ~ 0.010)	—
		Limit mm (in)	0.5 (0.020)	0.6 (0.024)	—
	Reverse Gear	Standard mm (in)	0.10 ~ 0.25 (0.004 ~ 0.010)	0.20 ~ 0.30 (0.008 ~ 0.012)	—
		Limit mm (in)	0.8 (0.031)	1.0 (0.040)	—
	Reverse Idler Gear	Standard mm (in)	0.07 ~ 0.39 (0.003 ~ 0.015)	0.05 ~ 0.50 (0.002 ~ 0.020)	—
		No. 0 mm (in)	2.240 ~ 2.290 (0.0882 ~ 0.0902)	—	—
Thrust Washer (Counter gear)	No. 1 mm (in)	2.300 ~ 2.350 (0.0901 ~ 0.0925)	—	—	
	No. 2 mm (in)	2.360 ~ 2.410 (0.0929 ~ 0.0949)	—	—	
	No. 3 mm (in)	2.420 ~ 2.470 (0.0953 ~ 0.0972)	—	—	
	No. 4 mm (in)	2.480 ~ 2.530 (0.0976 ~ 0.0996)	—	—	
	No. 5 mm (in)	2.540 ~ 2.590 (0.100 ~ 0.1020)	—	—	
	Thrust Washer (Reverse idler gear)	A	28.44 ~ 28.50 (1.120 ~ 1.122)	—	—
B		28.64 ~ 28.70 (1.128 ~ 1.102)	—	—	
C		28.84 ~ 28.90 (1.135 ~ 1.138)	—	—	
D		29.04 ~ 29.10 (1.143 ~ 1.146)	—	—	

MANUAL TRANSMISSION (2)

Vehicle Model		3 Speeds	4 & 5 Speeds	RA20L	
Snap Ring Thickness	Input Shaft	No. 1 mm (in)	2.05 ~ 2.10 (0.093 ~ 0.094)	2.35 ~ 2.40 (0.093 ~ 0.094)	2.05 ~ 2.10 (0.081 ~ 0.083)
		No. 2 mm (in)	2.10 ~ 2.15 (0.083 ~ 0.085)	2.40 ~ 2.45 (0.094 ~ 0.096)	2.10 ~ 2.15 (0.083 ~ 0.085)
		No. 3 mm (in)	2.15 ~ 2.20 (0.085 ~ 0.087)	2.45 ~ 2.50 (0.098 ~ 0.098)	2.15 ~ 2.20 (0.085 ~ 0.087)
		No. 4 mm (in)	2.20 ~ 2.25 (0.087 ~ 0.089)	2.50 ~ 2.55 (0.098 ~ 0.100)	2.25 ~ 2.25 (0.087 ~ 0.089)
		No. 5 mm (in)	2.25 ~ 2.30 (0.089 ~ 0.091)	2.55 ~ 2.60 (0.100 ~ 0.102)	2.25 ~ 2.30 (0.089 ~ 0.091)
		No. 6 mm (in)	2.30 ~ 2.35 (0.091 ~ 0.093)	—	2.30 ~ 2.35 (0.091 ~ 0.093)
	Countershaft (Reverse Gear)	No. 1 mm (in)	—	1.80 ~ 1.85 (0.071 ~ 0.073)	1.95 ~ 2.05 (0.077 ~ 0.081)
		No. 2 mm (in)	—	1.90 ~ 1.95 (0.075 ~ 0.077)	2.10 ~ 2.20 (0.083 ~ 0.086)
	Output Shaft (Front)	No. 1 mm (in)	—	1.95 ~ 2.00 (0.077 ~ 0.079)	1.85 ~ 1.90 (0.073 ~ 0.075)
		No. 2 mm (in)	—	2.00 ~ 2.05 (0.079 ~ 0.081)	1.90 ~ 1.95 (0.075 ~ 0.077)
		No. 3 mm (in)	—	2.05 ~ 2.10 (0.081 ~ 0.083)	1.95 ~ 2.00 (0.077 ~ 0.079)
		No. 4 mm (in)	—	2.10 ~ 2.15 (0.083 ~ 0.084)	—
		No. 5 mm (in)	—	2.15 ~ 2.20 (0.084 ~ 0.086)	—
	Output Shaft (Extension Housing)	No. 1 mm (in)	1.35 ~ 1.45 (0.053 ~ 0.057)	—	2.10 ~ 2.15 (0.083 ~ 0.085)
		No. 2 mm (in)	1.45 ~ 1.55 (0.057 ~ 0.061)	—	2.15 ~ 2.20 (0.085 ~ 0.087)
		No. 3 mm (in)	1.55 ~ 1.65 (0.061 ~ 0.065)	—	2.20 ~ 2.25 (0.087 ~ 0.089)
		No. 4 mm (in)	1.65 ~ 1.75 (0.065 ~ 0.069)	—	2.25 ~ 2.30 (0.089 ~ 0.091)
		No. 5 mm (in)	1.75 ~ 1.85 (0.069 ~ 0.073)	—	2.30 ~ 2.35 (0.091 ~ 0.093)
	Clearance limit between synchronizer ring and gear		0.8 (0.031)	—	—
	Clearance limit between shift fork and hub sleeve		1.0 (0.039)	—	—

TOYOGLIDE

2-SPEED

Shift Point				
	Speed (km/h)			
Adjustment	Low brake band		Screw in the anchor bolt fully, then screw it back 3.5 turns.	
	Shift lever		When manual valve outer lever positioned at "N" range, the shift lever indicator should align with "N" position.	
	Throttle link connecting rod		With the carburetor throttle valve fully opened, align the indicator with the mark on the transmission case.	
	Neutral safety switch		The engine must be started only when the shift lever positioned at "N" or "P" range.	
Oil pressure test	Line pressure test kg/cm ² (psi)		More than 7.5 (106.65) ("L" range at idle speed) More than 4.0 (56.88) ("D" & "R" range at idle speed) 8.5 ~ 9.5 (120.87 ~ 135.09) ("L", "D" & "R" range, with carburetor throttle valve fully opened)	
	Governor pressure test kg/cm ² (psi)		20 Km/h (12.4 mph)	1.6 ~ 2.0 (22.75 ~ 28.44)
			40 Km/h (25.0 mph)	2.6 ~ 3.2 (36.97 ~ 45.50)
		60 Km/h (37.3 mph)	3.8 ~ 4.2 (54.04 ~ 59.72)	
Stall RPM			1800 ~ 2100 rpm	
Front Oil Pump	Body Clearance	Limit mm (in)	0.25 mm (0.098")	
		Standard mm (in)	0.12 ~ 0.21 mm (0.0047 ~ 0.0083")	
	Side Clearance	Limit mm (in)	0.20 mm (0.0079")	
		Standard mm (in)	0.30 ~ 0.06 mm (0.0012 ~ 0.0024")	
Rear Oil Pump	Tip Clearance	Limit mm (in)	0.50 mm (0.0187")	
		Standard mm (in)	0.25 ~ 0.37 mm (0.0098 ~ 0.0146")	
	Body Clearance	Limit mm (in)	0.25 mm (0.0098")	
		Standard mm (in)	0.10 ~ 0.17 mm (0.0039 ~ 0.0067")	
Thrust Washer Thickness	Side Clearance	Limit mm (in)	0.20 mm (0.0079")	
		Standard mm (in)	0.03 ~ 0.06 mm (0.0012 ~ 0.0024")	
	Tip Clearance	Limit mm (in)	0.50 mm (0.0197")	
		Standard mm (in)	0.09 ~ 0.21 mm (0.0035 ~ 0.0083")	
Thrust Washer Thickness	Washer (Input sun gear thrust)		Limit mm (in)	1.7 mm (0.067")
			Standard mm (in)	2.0 mm (0.079")
	Low Sun Gear Thrust Washer	No. 1	Limit mm (in)	1.7 mm (0.067")
			Standard mm (in)	2.0 mm (0.079")
		No. 2	Limit mm (in)	2.3 mm (0.091")
			Standard mm (in)	2.6 mm (0.102")
Clutch Drum Thrust Washer		Limit mm (in)	1.4 mm (0.055")	
		Standard mm (in)	1.6 mm (0.063")	
Planetary Carrier Thrust Washer		Limit mm (in)	1.7 mm (0.067")	
		Standard mm (in)	1.9 ~ 2.0 mm (0.075 ~ 0.079")	
Planetary Pinion Thrust Washer		Limit mm (in)	0.3 mm (0.012")	
		Standard mm (in)	0.5 mm (0.020")	

9 – 14 SST LIST & SPECIFICATIONS – Specifications

		Bush finishing	Oil clearance limit	Oil clearance standard
Bush inner diameter	Clutch drum mm (in)	35.00 ~ 35.03 (1.3778 ~ 1.3791)	0.15 (0.006)	0.025 ~ 0.075 (0.0010 ~ 0.0030)
	Transmission case mm (in)	2.500 ~ 25.02 (0.9843 ~ 0.9850)	0.15 (0.006)	0.007 ~ 0.049 (0.0003 ~ 0.0019)
	Stator shaft mm (in)	15.50 ~ 15.52 (0.6102 ~ 0.6110)	0.15 (0.006)	0.016 ~ 0.052 (0.0006 ~ 0.0020)
	Front oil pump drive gear mm (in)	26.00 ~ 26.02 (1.0236 ~ 1.0244)	0.15 (0.006)	0.020 ~ 0.062 (0.0008 ~ 0.0024)
	Front oil pump body mm (in)	42.05 ~ 42.08 (1.6555 ~ 1.6567)	0.15 (0.006)	0.050 ~ 0.100 (0.0020 ~ 0.0039)
	Planetary carrier mm (in)	10.00 ~ 10.02 (0.3937 ~ 0.3945)	0.15 (0.006)	0.025 ~ 0.062 (0.0010 ~ 0.0024)
	Rear oil pump body mm (in)	25.00 ~ 25.02 (0.9843 ~ 0.9850)	0.15 (0.006)	0.007 ~ 0.049 (0.0003 ~ 0.0019)
	Extension housing mm (in)	32.00 ~ 32.03 (1.2598 ~ 1.2610)	0.15 (0.006)	0.009 ~ 0.059 (0.0004 ~ 0.0023)
Spring	Clutch piston mm (in)	Free length	Standard	43.0 mm (1.69)
	Low servo piston back mm (in)	Free length	Standard	42.6 mm (1.68)
	Low servo piston cushion mm (in)	Free length	Standard	20.5 mm (0.81)
	Pressure regulator valve	Free length	Limit	49.0 mm (1.93)
			Standard	52.5 mm (2.07)
	Shift valve (black paint) mm (in)	Free length	Limit	24.0 mm (0.94)
			Standard	28.0 mm (1.10)
	Throttle relay valve mm (in)	Free length	Limit	19.5 mm (0.08)
			Standard	23.0 mm (0.91)
	Orifice control valve	Free length	Limit	14.5 mm (0.57)
			Standard	16.0 mm (0.63)
	Throttle valve	Free length	Limit	15.5 mm (0.61)
			Standard	17.0 mm (0.67)
	Check valve	Free length	Limit	17.0 mm (0.67)
			Standard	22.0 mm (0.87)
Reverse piston back	Free length	Limit	28.5 mm (1.12)	
		Standard	32.5 mm (1.28)	
Governor valve	Free length	Limit	20.0 mm (0.79)	
		Standard	24.3 mm (0.96)	

3 SPEED TOYOGLIDE

Shift ratio		
	"D" Range	"2nd" and "L" Range
Adjustment	Front brake band	End of piston rod to apply bolt clearance : 3 mm (0.118") (with prying apply lever towards the band apply side)
	Rear brake band	Tighten the anchor bolt to 0.5 m-kg (3.6 ft-lb) torque, then screw it back 1 turn.
	Transmission end play	0.5 ~ 0.9 mm (0.020 ~ 0.036")
	Front multiple clutch	clearance 0.4 ~ 0.7 mm (0.016 ~ 0.028")
	Safety & Reverse switch	The engine must be started only when the shift lever positioned at "N" or "P" range. The back-up light must glow only with the shift lever in "R" range.
	Throttle link connecting rod	With the carburetor valve fully opened, align the indicator with the mark on the transmission case.
Oil pressure test	Front oil pump discharge pressure kg/cm ² (psi)	9.0 ~ 10.5 (128 ~ 149) With the throttle valve fully opened position in "L", "2" or "D" range.
		13.0 ~ 14.5 (185 ~ 206) With the throttle valve fully opened position in "R" range.
	Rear oil pump discharge pressure kg/cm ² (psi)	5.0 ~ 6.0 (71 ~ 85) with 57 km/h (35.4 mph)
	Governor pressure kg/cm ² (psi)	1.7 (24) with 29 km/h (18.0 mph) 2.7 (38) with 57 km/h (35.4 mph) 4.4 (63) with 86 km/h (53.4 mph)
Stall test revolution		1950 ~ 2200 rpm

Front oil pump	Body clearance	mm (in)	Specified clearance	0.120 ~ 0.209 (0.0047 ~ 0.0082)	Limit	0.3 (0.012)
	Side clearance	mm (in)		0.025 ~ 0.060 (0.0010 ~ 0.0024)		0.2 (0.008)
	Tip clearance	mm (in)		0.248 ~ 0.368 (0.0098 ~ 0.0145)		0.5 (0.020)
Rear oil pump	Body clearance	mm (in)	Specified clearance	0.100 ~ 0.170 (0.0039 ~ 0.0067)	Limit	0.25 (0.010)
	Side clearance	mm (in)		0.025 ~ 0.066 (0.0010 ~ 0.0024)		0.2 (0.008)
	Tip clearance	mm (in)		0.087 ~ 0.207 (0.0034 ~ 0.0082)		0.5 (0.020)
Front or rear servo piston to check valve gap				mm (in)	0.8 ~ 1.1 (0.003 ~ 0.04)	
Spring mm(in)	Spring for		Free length		Free length limit	
	1-2 shift valve		16.5 (0.65)		15 (0.60)	
	2-3 shift valve		26.0 (1.02)		23 (0.90)	
	orifice control valve		25.8 (1.02)		23 (0.90)	
	throttle valve (front)		23.5 (0.93)		21 (0.83)	
	throttle valve (rear)		17.5 (0.69)		16 (0.63)	
	throttle relay valve		19.0 (0.75)		16 (0.63)	
	governor valve		18.5 (0.73)		15.5 (0.61)	
	pressure regulator valve		52.8 (2.08)		50 (1.97)	
	manual valve lever		32.0 (1.26)		29 (1.14)	
	oil pump check valve		16.4 (0.65)		-	
	rear clutch piston return		43.4 (1.71)		-	
	front servo piston return		41.0 (1.62)		-	
	front servo piston cushion		23.6 (0.93)		-	
	front clutch piston return		7.0 (0.28)		6.0 (0.24)	
Thrust washer thickness mm (in)	Thrust washer for		Specified thickness		Limit	
	planetary pinion		1.6 (0.063)		1.2 (0.048)	
	front clutch hub x input shaft		2.0 (0.079)		1.6 (0.063)	
	planetary carrier x transmission case		1.2 or 0.8 (0.047 or 0.032)		-	
	front clutch drum x second sun-gear		4.0 (0.158)		3.6 (0.142)	
Spacer thickness for governor body			mm (in)		1.2 (0.047)	

PROPELLER SHAFT • UNIVERSAL JOINT

Spider bearing cup dia.	w/o mark	26.00 ~ 26.02 mm (1.0236 ~ 1.0244")
	w/ mark	26.02 ~ 26.04 mm (1.0244 ~ 1.0251")
Spider bearing cup bore dia.	w/o red mark	26.02 ~ 26.03 mm (1.0244 ~ 1.0248")
	w/red mark	26.04 ~ 26.05 mm (1.0251 ~ 1.0256")
Hole snap ring thickness	No. 1	2.43 mm (0.096")
	No. 2	2.48 mm (0.098")
	No. 3	2.53 mm (0.100")
	No. 4	2.58 mm (1.102")
Spider thrust play		0.05 mm (0.002")

DIFFERENTIAL

Model		TA10, 12, 20, 22	TA12-S, TA20-K, TA22-K	TA10-Y	RA-20L
Number of teeth	Drive pinion	9	10	8	10
	Ring gear	37	39	35	37
Gear ratio		4.111	3.9	4.375	3.700
Drive pinion bearing pre-load	New bearing kg (lb)	10 ~ 16 kg-cm 100; SST (2.0 ~ 2.8)			
Total pre-load	New bearing kg (lb)	Drive pinion pre-load 2 ~ 4 kg-cm (0.3 ~ 0.6 ft-lb) 100φ SST 2.0 ~ 2.8 + 0.4 ~ 0.8 (4.1 ~ 5.7) + (0.8 ~ 1.6)			
Differential case side bearings pre-load		Tighten both nuts until ring gear has no play then tighten one side nut additionally, 1.0 ~ 1.5 notches.			
Drive pinion and ring gear backlash	mm (in)	0.13 ~ 0.18 (0.005 ~ 0.007")			
Ring gear	mm (in)	0.05 (0.02")			
Diff. case run-out limit	mm (in)	0.05 (0.02")			
Side gear backlash	mm (in)	0.02 ~ 0.20 (0.0027 ~ 0.0079")			
Side gear thrust clearance	mm (in)	0.05 ~ 0.35 (0.0019 ~ 0.0138")			
Drive pinion spacer thickness	No. 1 mm (in)	44.95 ~ 44.98 (1.7697 ~ 1.7709)			
	No. 2 mm (in)	44.99 ~ 44.02 (1.7713 ~ 1.7331)			
	No. 3 mm (in)	45.03 ~ 45.06 (1.7728 ~ 1.7740)			
	No. 4 mm (in)	45.07 ~ 45.10 (1.7744 ~ 1.7756)			
	No. 5 mm (in)	45.11 ~ 45.14 (1.7760 ~ 1.7772)			
	No. 6 mm (in)	45.15 ~ 45.18 (1.7776 ~ 1.7787)			
Shim (for spacer adjustment)	mm (in)	0.25 (0.010)			
Plate washer thickness (for drive pinion adjustment)	No. 1 mm (in)	2.52 ~ 2.54 (0.0992 ~ 0.1000)			
	No. 2 mm (in)	2.55 ~ 2.57 (0.1003 ~ 0.1012)			
	No. 3 mm (in)	2.58 ~ 2.60 (0.1016 ~ 0.1024)			
	No. 4 mm (in)	2.61 ~ 2.63 (0.1028 ~ 0.1035)			
	No. 5 mm (in)	2.64 ~ 2.66 (0.1039 ~ 0.1047)			
	No. 6 mm (in)	2.67 ~ 2.69 (0.1051 ~ 0.1059)			
	No. 7 mm (in)	2.70 ~ 2.72 (0.1063 ~ 0.1071)			
	No. 8 mm (in)	2.73 ~ 2.75 (0.1075 ~ 0.1083)			
	No. 9 mm (in)	2.76 ~ 2.78 (0.1087 ~ 0.1094)			
Drive pinion adjusting shim thickness	mm (in)	0.25 (0.010")			
Side gear thrust washer thickness	No. 1 mm (in)	1.47 ~ 1.53 (0.0579 ~ 0.0602)			
	No. 2 mm (in)	1.52 ~ 1.58 (0.0600 ~ 0.0622)			
	No. 3 mm (in)	1.57 ~ 1.63 (0.0618 ~ 0.0642)			

FRONT AXLE

Wheel alignment (No load)	Toe-in mm (in)		6 ± 1 (0.24 ± 0.04)	
	Camber		1° ± 30'	
	Caster		1° ± 30'	
	Axis inclination		7°30'	
	Turning angles	inside	39° ± 1° 2°	
		outside	32° ± 2° 4°	
Side slip	Within 3 mm at meter (within 0.118" at 3.3 ft)			
Wheel bearing pre-load	Tighten the castle nut to 2.6 ~ 3.2 m·kg (18.80 ~ 23.14 ft·lbs) torque, rotate the drum 2 ~ 3 turns, and loosen the nut until it turns with the fingers. Insert a box wrench, and tighten the nut with the box wrench by the hand.			

CAUTION : To perform the front alignment measurement or adjustment, always adjust the car height.

FRONT SUSPENSION

Coil Spring	Free Length mm (in)		Models	TA10, 12 series	TA22, RA20L series
	White	405 (15.9")		Installed load kg (lb)	263~279 (540.1~573)
Blue	413 (16.3")	275~291 (564.8~597.6)	—		
Red	389 (15.3")	—	262~278 (538.1~570.9)		
Yellow	397 (15.6")	—	274~290 (562.7~595.6)		
Front shock absorber	Max length mm (in)		631.4 (24.86)	616.4 (24.27)	
	Min. length mm (in)		439.4 (17.30)	424.4 (16.71)	

REAR SUSPENSION

Coil Spring	Free length mm (in)		Models	TA10, 12 series	TA22, RA20L series
	Blue	378 (14.88")		Installed load	230~244 (472.3~501.1)
Green	236~250 (484.7~513.4)		—		
Red	361 (14.21")	—	201~210 (412.8~431.3)		
Yellow		—	210~219 (431.3~449.7)		
Rear shock absorber	Max length mm (in)		568~571 (22.36~22.48)	561~564 (22.09~22.20)	
	Min. length mm (in)		338~341 (13.31~13.43)	357~361 (14.06~14.21)	

WHEEL

Disc wheel run-out limit	3 mm (0.118")
--------------------------	---------------

STEERING

Gear ratio		18.18		
Steering wheel play	mm (in)	0 ~ 20 (0.787")		
Clearance between sector and bushing	mm (in)	No. 1	No. 2	No. 3
		0.03 ~ 0.07 (0.001)	0.01 ~ 0.05 (0.0004 ~ 0.0020")	

Bushing dia.	mm (in)	28.02 ~ 28.05 (11.03)	28.00 ~ 28.03 (1.1024 ~ 1.1035")
Sector shaft dia.	mm (in)	27.98 ~ 27.99 (1.1016 ~ 1.1020")	
Sector shaft thrust clearance	mm (in)	less than 0.05 (less than 0.0020")	
Sector shaft thrust washer thickness	A mm (in)	2.00 (0.0787")	
	B mm (in)	2.04 (0.0803")	
	C mm (in)	2.08 (0.0819")	
	D mm (in)	2.12 (0.0835")	
	E mm (in)	2.16 (0.0850")	
	F mm (in)	2.20 (0.0866")	
Worm bearing pre-load	w/o sector shaft	kg (lb)	4.0 ~ 5.0 (8.2 ~ 10.3)
	w/ sector shaft	kg (lb)	8.0 ~ 11.0 (16.4 ~ 22.6)

BRAKE PEDAL

Pedal height	161.0 mm (6.34 in)
Pedal play	1.0 ~ 5.0 mm (0.04 ~ 0.20 in)
Effective pedal travel	More than 55 mm (2.17 in)

MASTER CYLINDER

Cylinder dia.	Drum Brake	17.46 ~ 17.51 mm (0.6874 ~ 0.6894)
	Disc Brake	20.64 ~ 20.69 mm (0.8126 ~ 0.8146)

Breake

Parking brake lever travel	3 ~ 7 notches
----------------------------	---------------

FRONT BRAKE (DISC TYPE)

Dist thickness	Limit	9.0 mm (0.354 in)
	Standard	10.0 mm (0.394 in)
Disc run-out-limit		0.15 mm (0.006 in)
Pad thickness	Limit	1.0 mm (0.039 in)
	Standard	9.0 mm (0.354 in)

FRONT BRAKE (DRUM TYPE)

Wheel cylinder dia.		23.81 mm (0.937 in)
Drum dia.	Limit	230.6 mm (9.078 in)
	Standard	228.6 mm (9.000 in)
Lining thickness	Limit	1.5 mm (0.059 in)
	Standard	5.0 mm (0.197 in)
	O/S	0.5 mm (0.020 in)

REAR BRAKE

Type			Drum Brake	Disc Brake
Wheel cylinder dia.		mm (in)	15.87 (0.625)	19.05 (0.750)
Brake drum dia.	Limit	mm (in)	230.60 (9.079)	--
	Standard	mm (in)	228.60 (9.000)	--
Lining thickness	Limit	mm (in)	1.0 (0.039)	--
	Standard	mm (in)	5.0 (0.197)	--
	O/S	mm (in)	0.5 (0.020)	--

LUBRICATION

ITEM	RECOMMENDED OIL	CAPACITY
Engine: Crankcase Oil filter	API service classification SD or SC w/proper viscosity	3.1 (3.3 US qts., 2.7 Imp qts.) 0.8 (0.9 US qts., 0.7 Imp qts.)
Transmission: 3-speed 4-speed	API service classification GL-4 w/SAE 80	1.7 (1.8 US qts., 1.5 Imp qts.) 1.54 (1.6 US qts., 1.4 Imp qts.)
Toyoglide: 2-speed 3-speed	Automatic transmission fluid	4.7 (5.0 US qts., 4.1 Imp qts.) 7.0 (7.4 US qts., 6.2 Imp qts.)
Differential	HYPOIDGEAR LUBRICANT API service classification GL-4 w/SAE 90	1.0 (1.1 US qts., 0.9 Imp qts.)
Steering gear box	API service classification GL-4 w/SAE 90	0.24 (0.3 US qts., 0.2 Imp qts.)
Brake fluid	SAE 70R3 (SAE J1703)	--
Wheel bearing	Multipurpose grease (M.P.) w/NLGI classification No. 2	--
Chassis grease fittings	Chassis grease of M.P. grease w/NLGI classification No. 1	--

Prepared by

TOYOTA MOTOR SALES CO., LTD.

Export-Technical Department
Haruhi plant

Haruhi mura, Nishikasugai-gun
Aichi pref., Japan

May 1971

No. 98061

Printed in Japan

RECOMMENDED LUBRICANT

		BP	CALTEX	CHEVRON	ESSO	MOBIL	SHELL	SUN	TEXCO	TOTAL
Engine Oil	API SD	BP Super Viscostatic 5W/20, 10W/40,20W/50 BP Energol HD Oil 10W,20W,30,40	Custom Five Star Motor Oil 10W/30,10W/40, 20W/40,20W/50	Chevron Custom Motor Oil 10W/40 Chevron Special Motor Oil 10W,20W/20, 30,40,50	Esso Uniflo 5W/30,10W/40	Mobiloil Super 5W/30,10W/50, 20W/50 Mobiloil 5W/20,10W, 20W/20,20W/30, 30,40,50	Super Motor Oil 10W/30,20W/50	Sunoco Special 5W/30,10W/40, 20W/50 Sunoco Sunlube 10W,20W/20, 30,40,50	Havoline Super Premium Motor Oil 5W/30,10W/40, 20W/50 Havoline Motor Oil 5W/20,10W/30, 10W/40,10W,20W/20, 30,40,50	Altigrade GTS 10W/30,10W/40, 20W/40,20W/50
	API SC		Five Star Motor Oil 10W,20W/20, 30,40,50		Esso Motor Oil 10W,20W 30,40,50		X-100 5W,10W,20W, 30,40,50			Super HD 10W,20,30,40,50
Gear Oil Steering Gear Transmission	API GL-4	BP Gear Oil EP 80,90,140	Universal Thuban 80,90,140	Chevron Multi-service Gear Lubricant 75,80,90,140	Esso Gear Oil GP 80,90,140	Mobilube GX 80,90,140	Spirax 75,80,90,140	Sun Dual-purpose Gear Oil 75,80,90,140,250	Universal Gear Lubricant EP 80,90,140	Extreme Pression 80,90,140
Gear Oil (Differential)	API GL-5	BP Hypogear Oil EP	Multipurpose Thuban EP 80,90,140	Chevron Universal Gear Lubricant 75,80,90,140	Esso Gear Oil GX 80,90,140	Mobilube HD 80,80/90,90,140	Spirax HD 80,90,140	Sunoco Multi-purpose Gear Lubricant 80,90,140	Multigear Lubricant EP 80,90,140	Extreme Pression Type B 80,90,140
Automatic Transmission Fluid	ATF Type F	BP Autran B	Texamatic Type F	Chevron ATF Special	Glide	Mobil ATF 210	Donax T7	Sunoco Transmatic Fluid Ford Type	Texamatic Type F	ATF 33
Chassis Grease (Ball Joint)	NLGI No.1 or No.2	BP Energrease L21M	Molytex Grease 2	Chevron Moly Grease 1 or 2	Beacon Q2	Mobilgrease Special	Retinax AM	Sunoco Multi-duty Grease 1M3 or 2M3	Molytex Brease No. 2	Multis MS
Wheel Bearing Grease	NLGI No. 2	BP Energrease L2	Marfak Multipurpose 2	Chevron Multi-Motive Grease 2	Esso Multipurpose Grease	Mobilgrease MP or JL	Retinax A	Sunoco Prestige Grease 742EP	Marfak Multi-purpose 2	Multis
Brake Fluid	SAE70R3 (SAE J1703)	BP Disc Brake Fluid	Caltex Heavy Duty Brake Fluid	Atlas Special Heavy Duty Brake Fluid 550	Atlas Brake Fluid SHD450 (U.S.A.) Esso Extra Heavy Duty Brake Fluid (Canada) Esso Brake Fluid HD400 (Far East) Esso Brake Fluid (Europe)	Mobil Super Heavy Duty Brake Fluid	Donax B	Sunoco Brake Fluid 550	Texaco Syper Heavy Duty	Brake Fluid
Anti-freeze [LLC Long Life Coolant]		BP Antifrost (LLC)	Startex Anti-freeze Coolant (LLC)	Atlas Perma-guard Anti-freeze & Coolant (LLC)	Atlas Permaguard Anti-freeze (USA) (LLC) Esso-Rad Anti-freeze (Canada) (LLC) Essolong Life Coolant (Far East) (LLC) Esso Anti-freeze (Europe)	Mobil Cooling System Conditioner (LLC)	Shellzone (LLC)	Sunoco Multi-season Anti-freeze	Texaco Anti-freeze Coolant (LLC)	Antigel (LLC)

ELECTRICAL WIRING DIAGRAM (TA10, 12 Series)

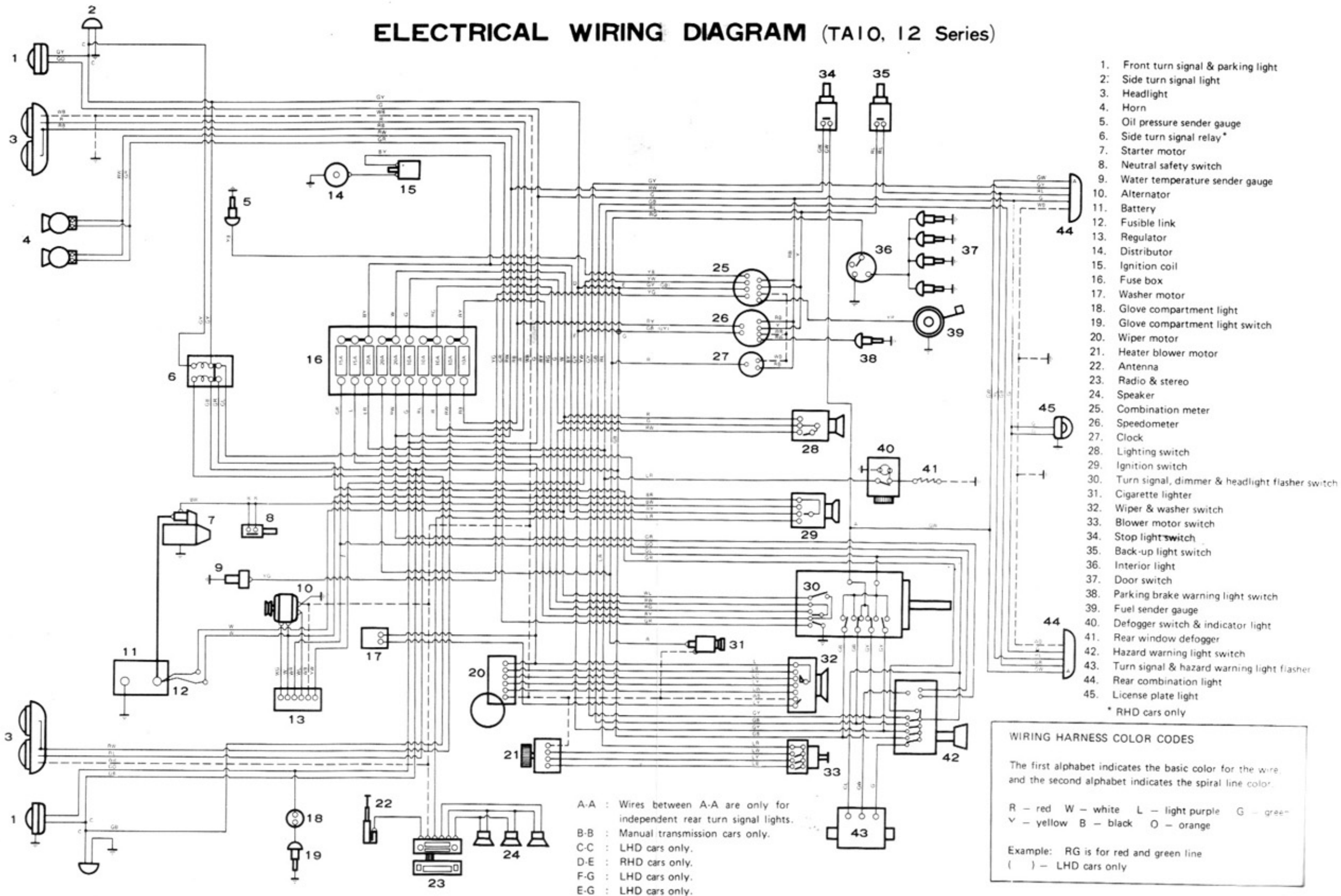

1. Front turn signal & parking light
 2. Side turn signal light
 3. Headlight
 4. Horn
 5. Oil pressure sender gauge
 6. Side turn signal relay*
 7. Starter motor
 8. Neutral safety switch
 9. Water temperature sender gauge
 10. Alternator
 11. Battery
 12. Fusible link
 13. Regulator
 14. Distributor
 15. Ignition coil
 16. Fuse box
 17. Washer motor
 18. Glove compartment light
 19. Glove compartment light switch
 20. Wiper motor
 21. Heater blower motor
 22. Antenna
 23. Radio & stereo
 24. Speaker
 25. Combination meter
 26. Speedometer
 27. Clock
 28. Lighting switch
 29. Ignition switch
 30. Turn signal, dimmer & headlight flasher switch
 31. Cigarette lighter
 32. Wiper & washer switch
 33. Blower motor switch
 34. Stop light switch
 35. Back-up light switch
 36. Interior light
 37. Door switch
 38. Parking brake warning light switch
 39. Fuel sender gauge
 40. Defogger switch & indicator light
 41. Rear window defogger
 42. Hazard warning light switch
 43. Turn signal & hazard warning light flasher
 44. Rear combination light
 45. License plate light
- * RHD cars only

WIRING HARNESS COLOR CODES

The first alphabet indicates the basic color for the wire and the second alphabet indicates the spiral line color.

R - red W - white L - light purple G - green
 Y - yellow B - black O - orange

Example: RG is for red and green line
 () - LHD cars only

A-A : Wires between A-A are only for independent rear turn signal lights.
 B-B : Manual transmission cars only.
 C-C : LHD cars only.
 D-E : RHD cars only.
 F-G : LHD cars only.
 E-G : LHD cars only.

ELECTRICAL WIRING DIAGRAM (TA22 Series)

WIRING HARNESS COLOR CODES

The first alphabet indicates the basic color for the wire, and the second alphabet indicates the spiral line color.

R=red W=white L=light purple G=green Y=yellow
B=black O=orange

Example: RG is for red and green line.

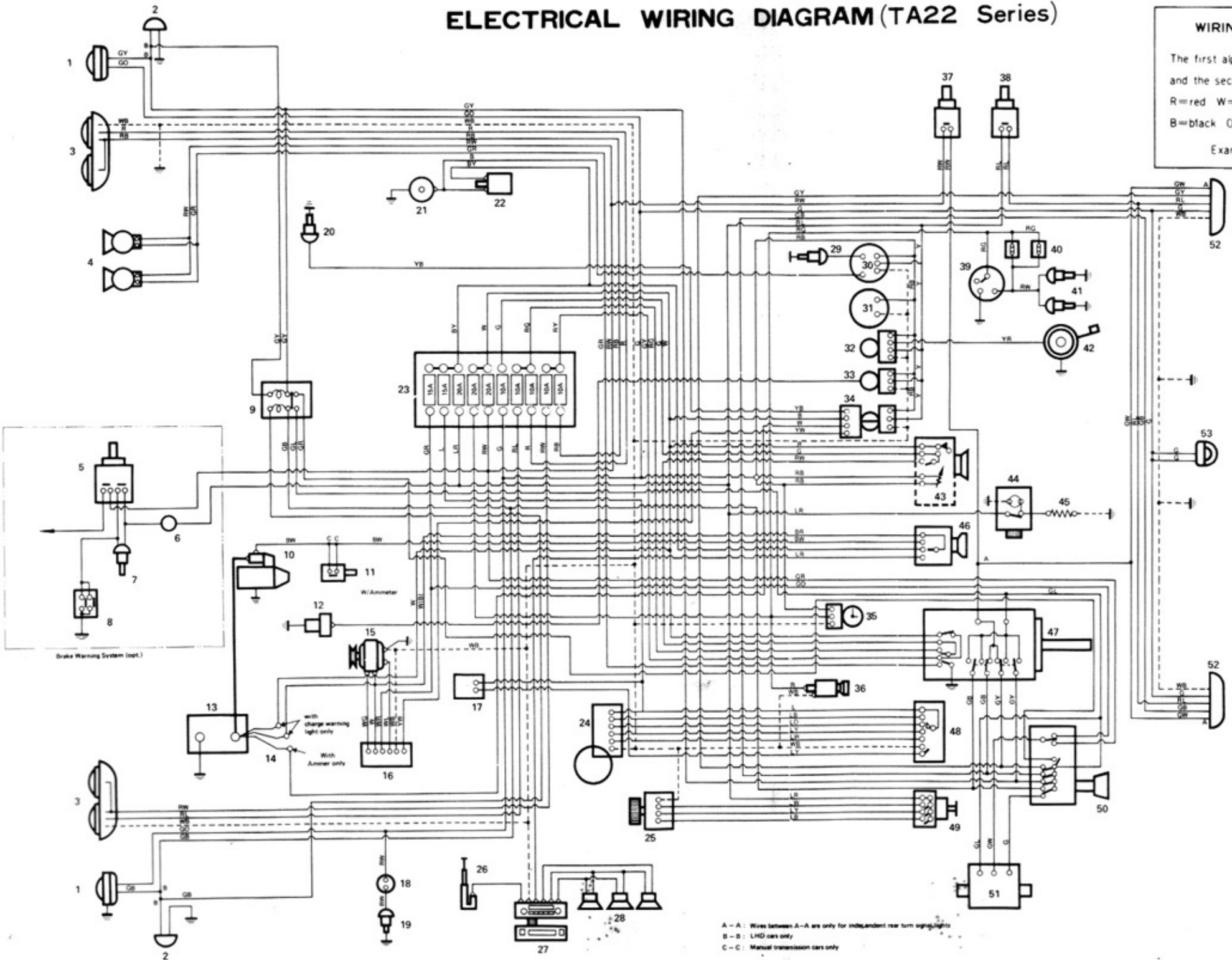

1. Front turn signal & parking light
2. Side turn signal light
3. Headlight
4. Horn
5. Stop light switch
6. Parking brake warning light
7. Parking brake warning light switch
8. Brake system warning light switch
9. Side turn signal relay* (RHD cars only)
10. Starter motor
11. Neutral safety switch (Toyoglide only)
12. Water temperature sender gauge
13. Battery
14. Fusible link
15. Alternator
16. Regulator
17. Washer motor
18. Glove compartment light
19. Glove compartment light switch
20. Oil pressure sender gauge
21. Distributor
22. Ignition coil
23. Fuse box
24. Wiper motor
25. Heater blower motor
26. Antenna
27. Radio & stereo
28. Speaker
29. Parking brake warning light switch
30. Tachometer
31. Speedometer
32. Fuel gauge
33. Water temperature gauge
34. Charge & oil pressure warning light
Ammeter & oil pressure gauge
35. Clock
36. Cigarette lighter
37. Stop light switch
38. Back-up light switch
39. Interior light
40. Door courtesy light
41. Door switch
42. Fuel sender gauge
43. Lighting switch
44. Defogger switch & indicator light
45. Rear window defogger
46. Ignition switch
47. Turn signal, dimmer & headlight flasher switch
48. Wiper & washer switch
49. Blower motor switch
50. Hazard warning light switch
51. Turn signal & hazard warning light flasher
52. Rear combination light
53. License plate light

A - A : Wires between A-A are only for independent rear turn signals
B - B : LHD cars only
C - C : Manual transmission cars only

ELECTRICAL WIRING DIAGRAM (RA20-L)

WIRING HARNESS COLOR CODES

The first alphabet indicates the basic color for the wire, and the second alphabet indicates the spiral line color
 R=red W=white L=light purple G=green Y=yellow
 B=black O=orange

Example RG is for red and green line.

1. Front turn signal & parking light
2. Headlight
3. Horn
4. Speed marker relay
5. Vacuum switching valve
6. Computer
7. Thermo sensor
8. Shift sensor
9. Stop light switch
10. Parking brake warning light
11. Parking brake warning light switch
12. Brake system warning light switch
13. Battery
14. Fusible link
15. Side marker light
16. Oil pressure sender gauge
17. Distributor
18. Ignition coil
19. Starter motor
20. Water temperature sender gauge
21. Alternator
22. Regulator
23. Washer motor
24. Glove compartment light
25. Glove compartment light switch
26. Fuse box
27. Wiper motor
28. Heater blower motor
29. Antenna
30. Radio & stereo
31. Speaker
32. Tachometer
33. Speedometer
34. Fuel gauge
35. Water temperature gauge
36. Ammeter & oil pressure gauge
37. Clock
38. Cigarette lighter
39. Back-up light switch
40. Interior light
41. Door courtesy light
42. Door switch
43. Fuel sender gauge
44. Lighting switch
45. Defogger switch & indicator light
46. Rear window defogger
47. Ignition switch
48. Lock warning buzzer
49. Lock warning switch
50. Door switch
51. Turn signal & dimmer switch
52. Wiper & washer switch
53. Blower motor switch
54. Hazard warning light switch
55. Turn signal & hazard warning light flasher
56. Side marker light
57. Rear combination light
58. License plate light

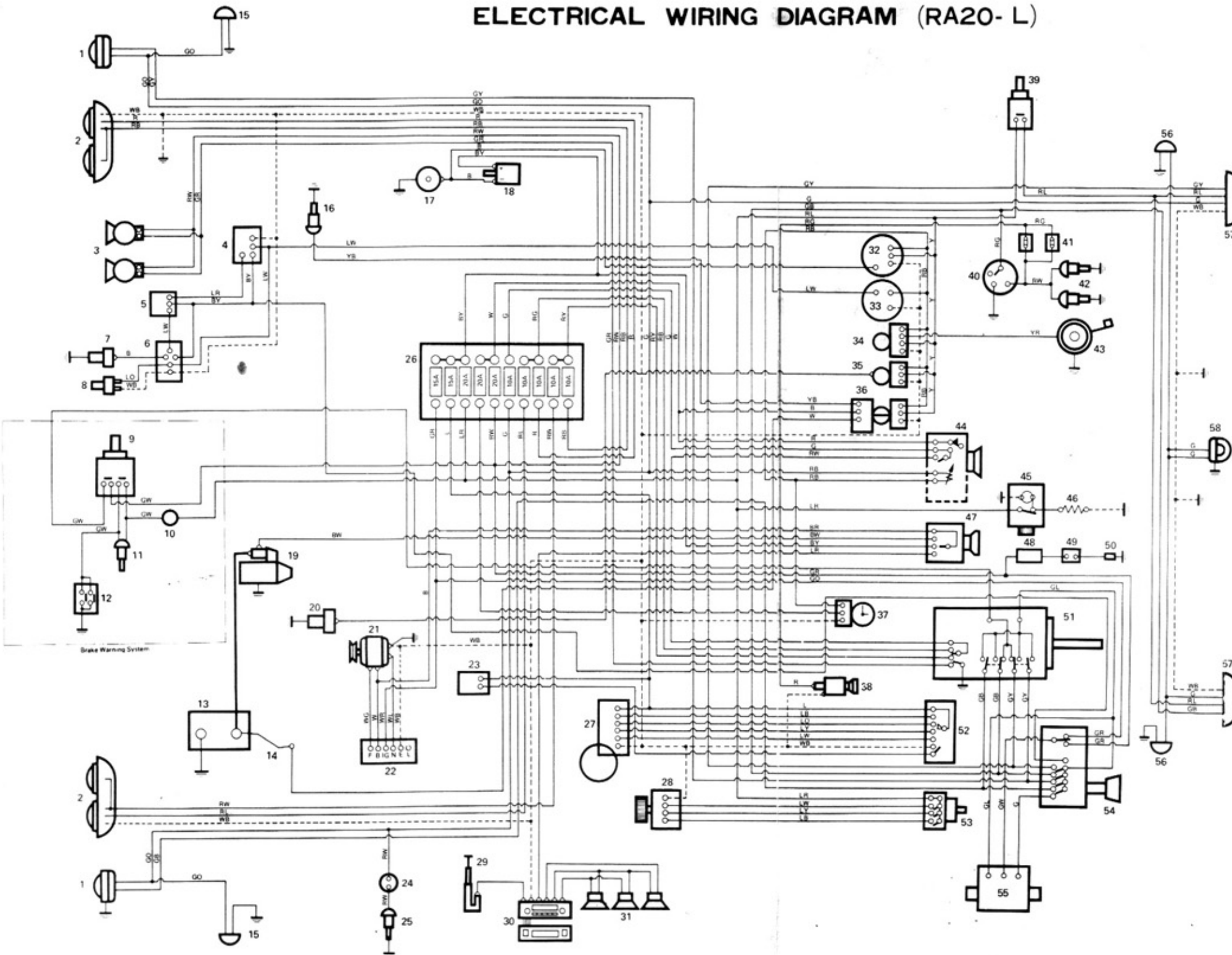

TOYOTA  MOTOR